

infrastructure

acoustics

energy

connection

light

growth

water

Water

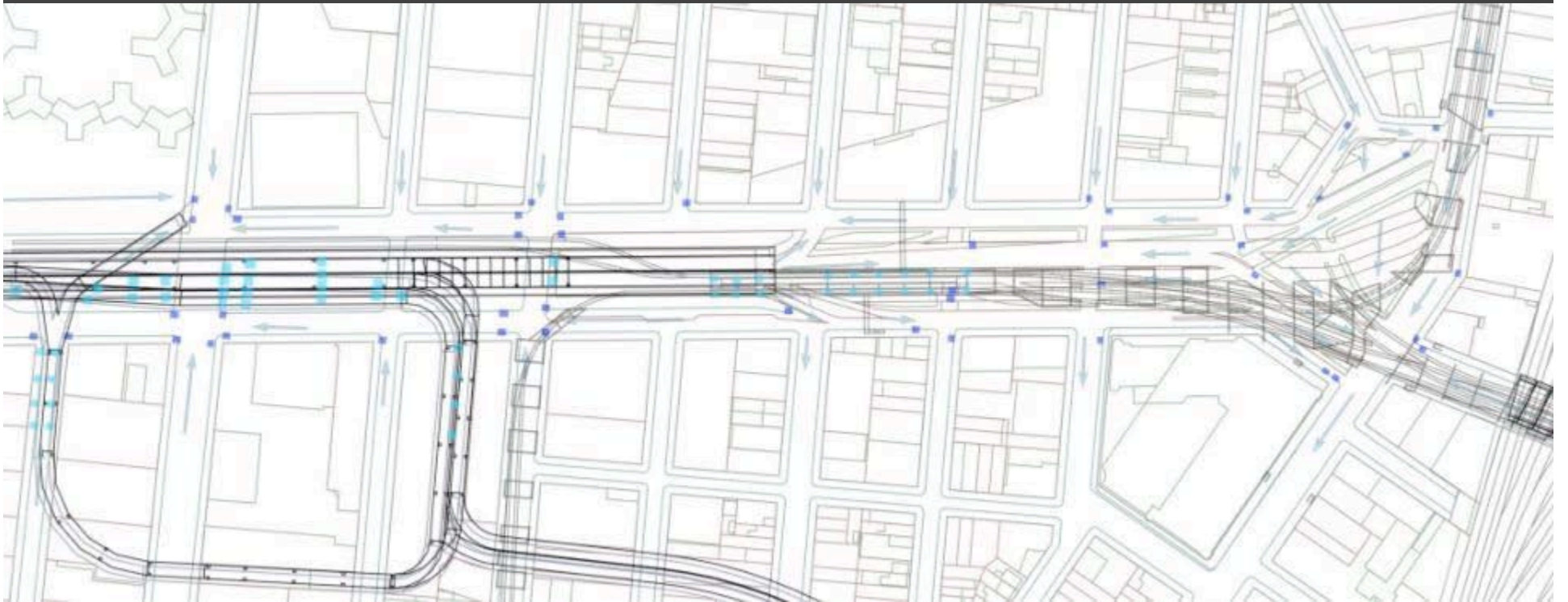

WATER SYSTEMS

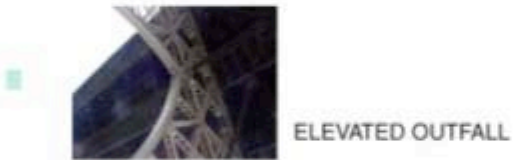

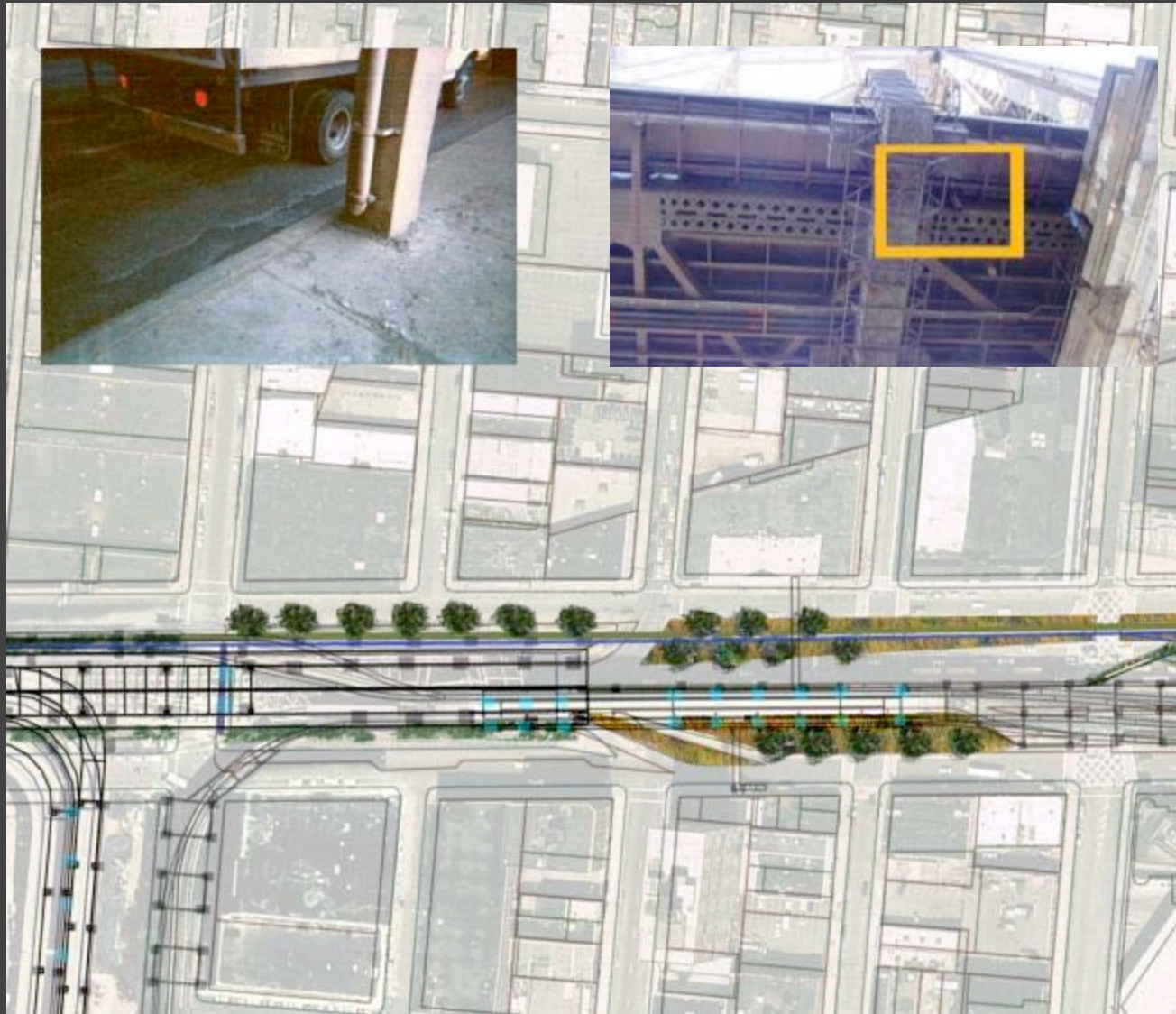







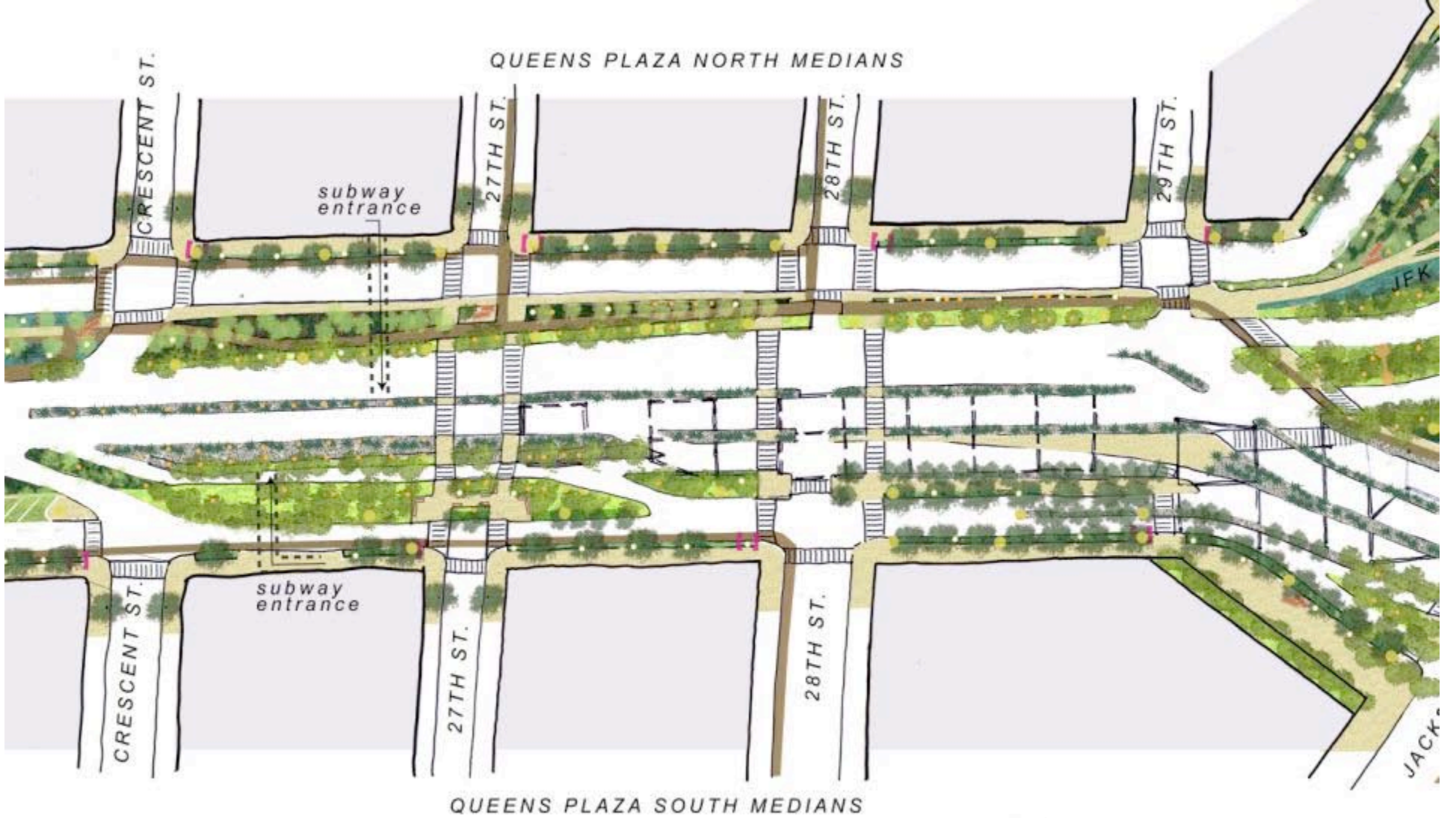

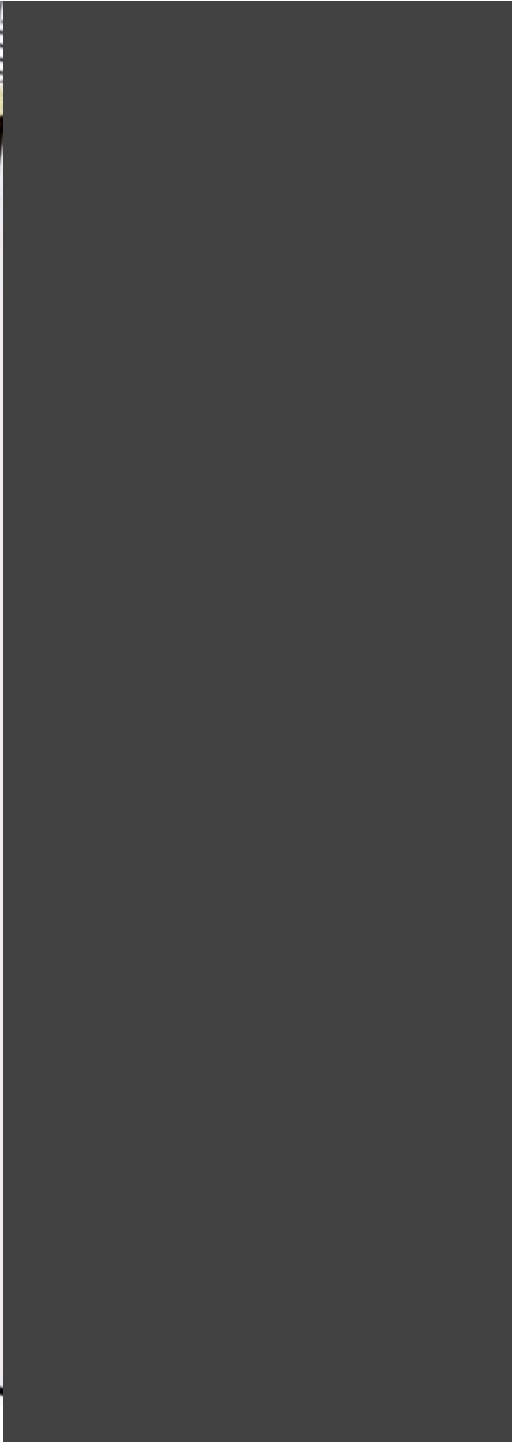









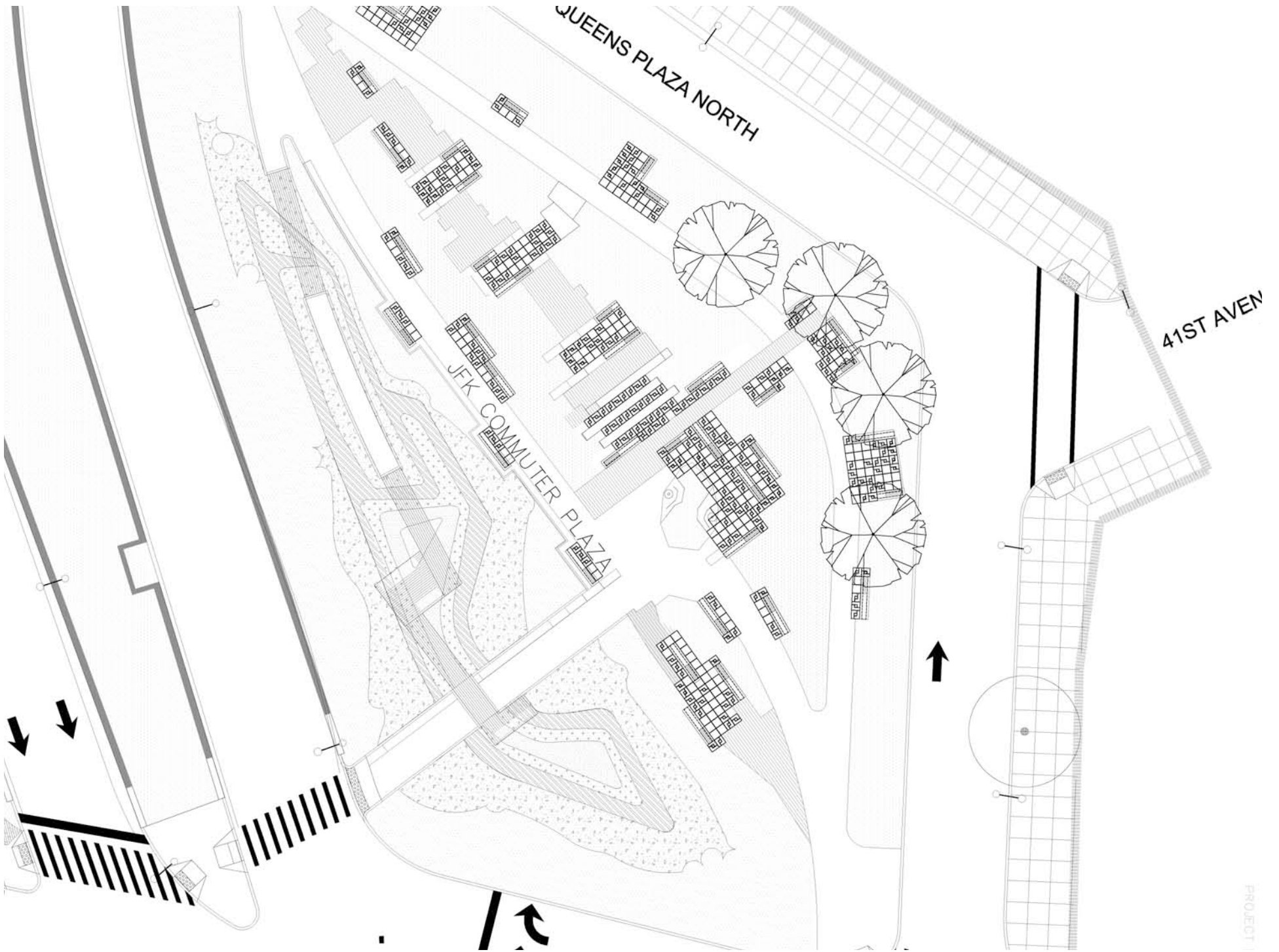

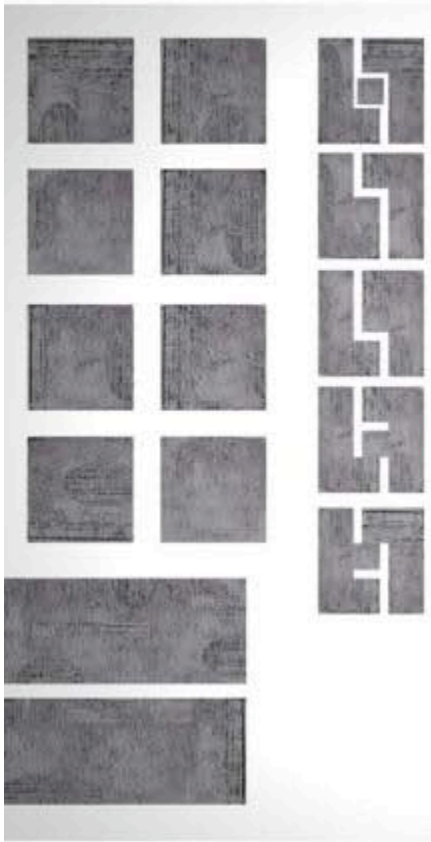

element type **P1**

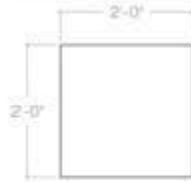

element type **P2**
multiple configurations

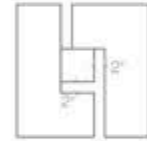
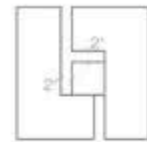
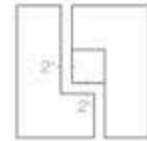
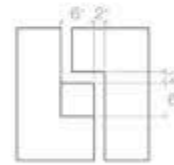
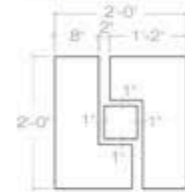

element type **P3**

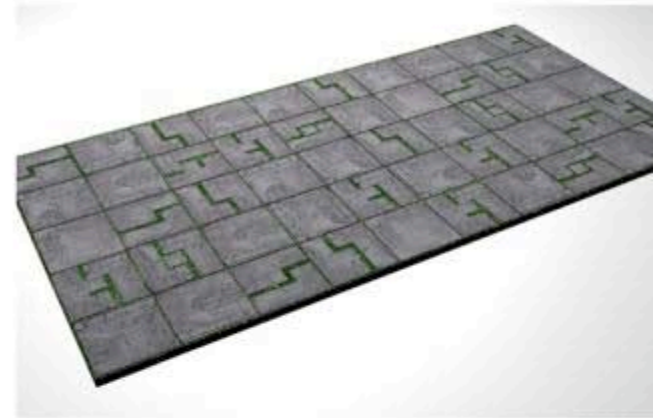
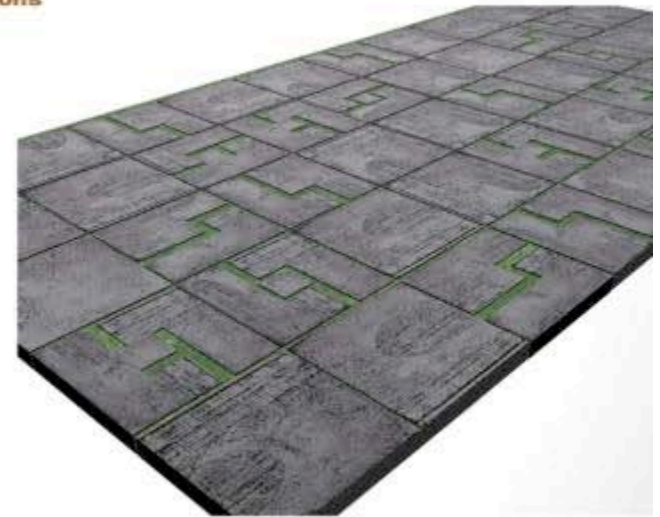
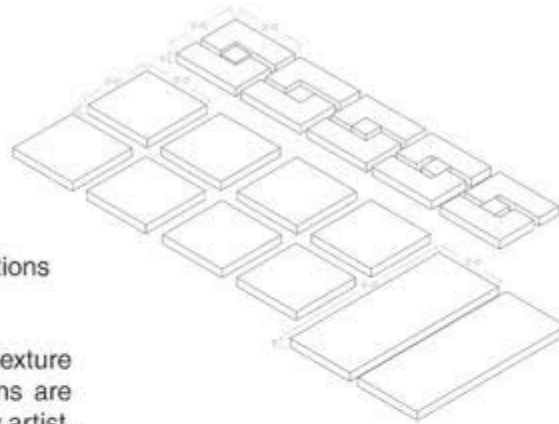

er Units and Permeable Paving Configurations
id on the 2'x2' modules, 3" depth standard

P2, and P3 elements have pattern and texture
the top surface only. Textures and patterns are
vided by artist and placed during casting by artist.
ture and pattern depth will not exceed 1/4".

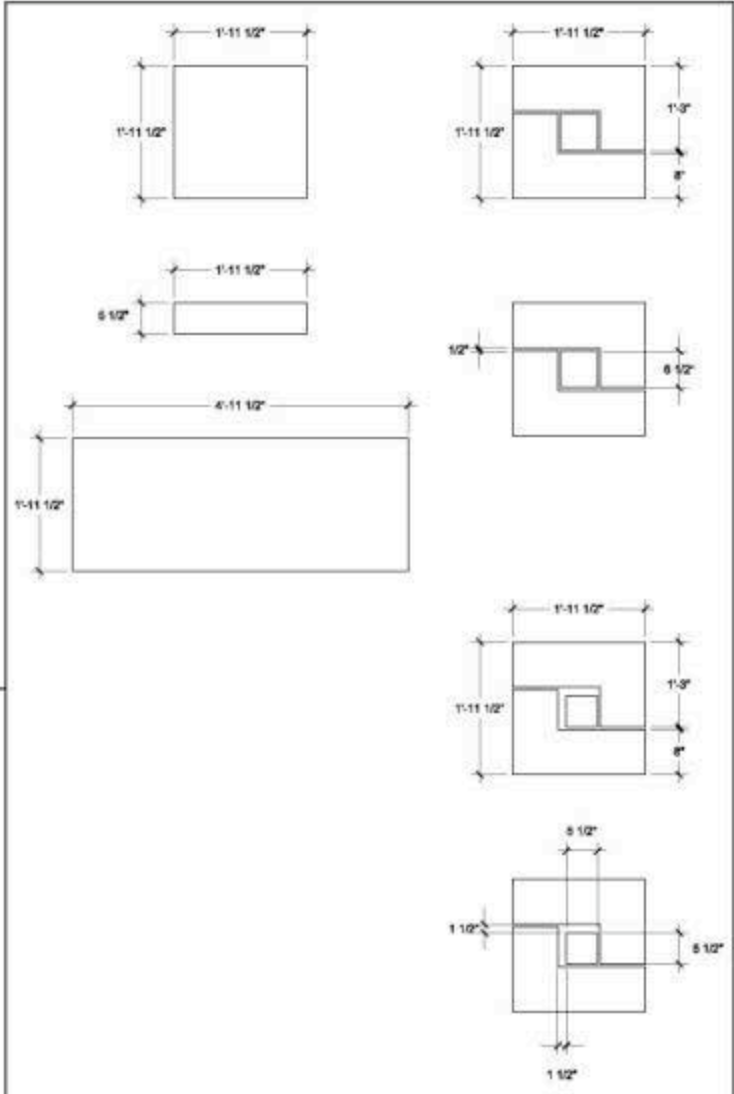
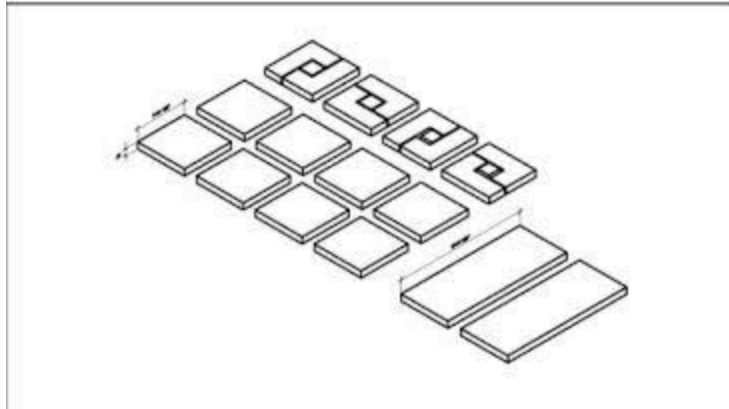

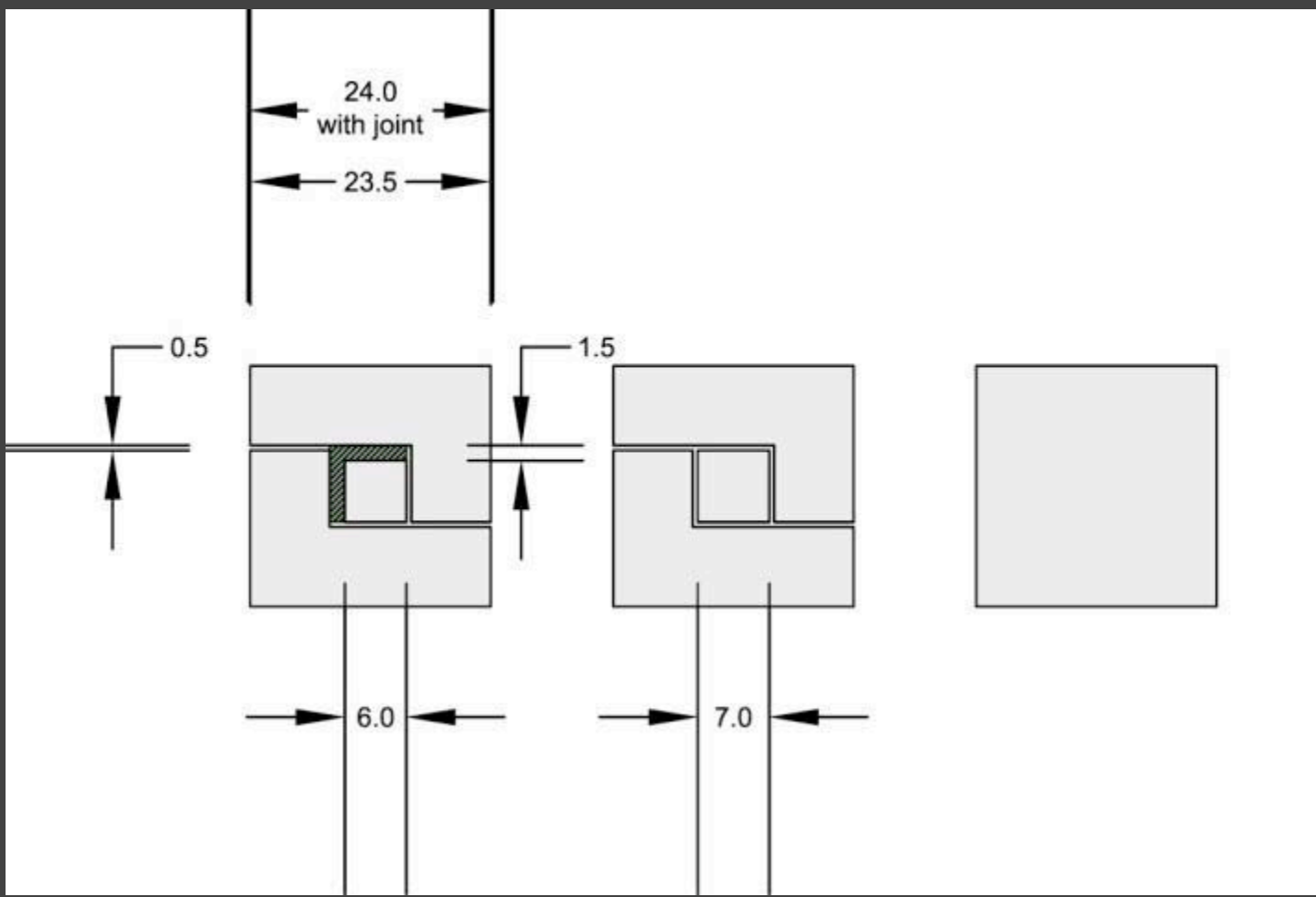

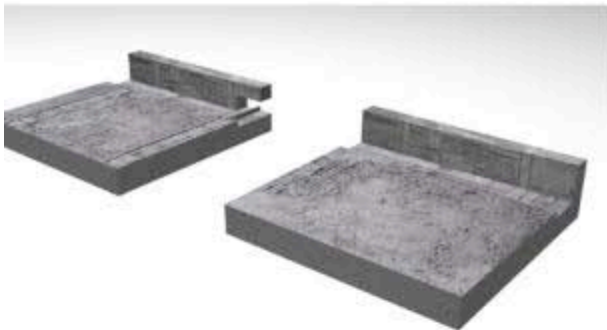

element type **R1**

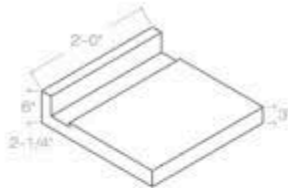
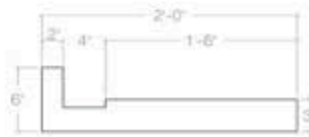
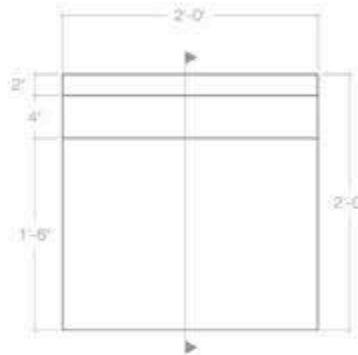

element type **R2**

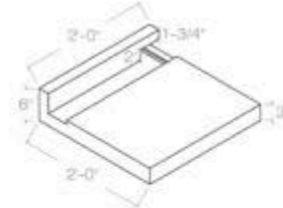
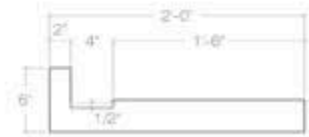
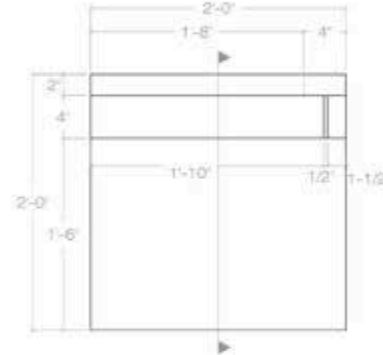

Custom Runnel Pavers with Weep Holes

2'x 2' modular units designed to collect water from spaces/paths and direct flow in to plant beds

R1 and R2 elements have pattern and texture on two sides. Textures and patterns are provided by artist and placed during casting by artist. R2 elements require a metal insert (which helps to direct water flow) to be specified by artist and approved by design team.

Custom Runnel Pavers with Weep Hole

2'x2' modular units designed to collect water from spaces/paths and direct flow in to plant beds, example spans shown

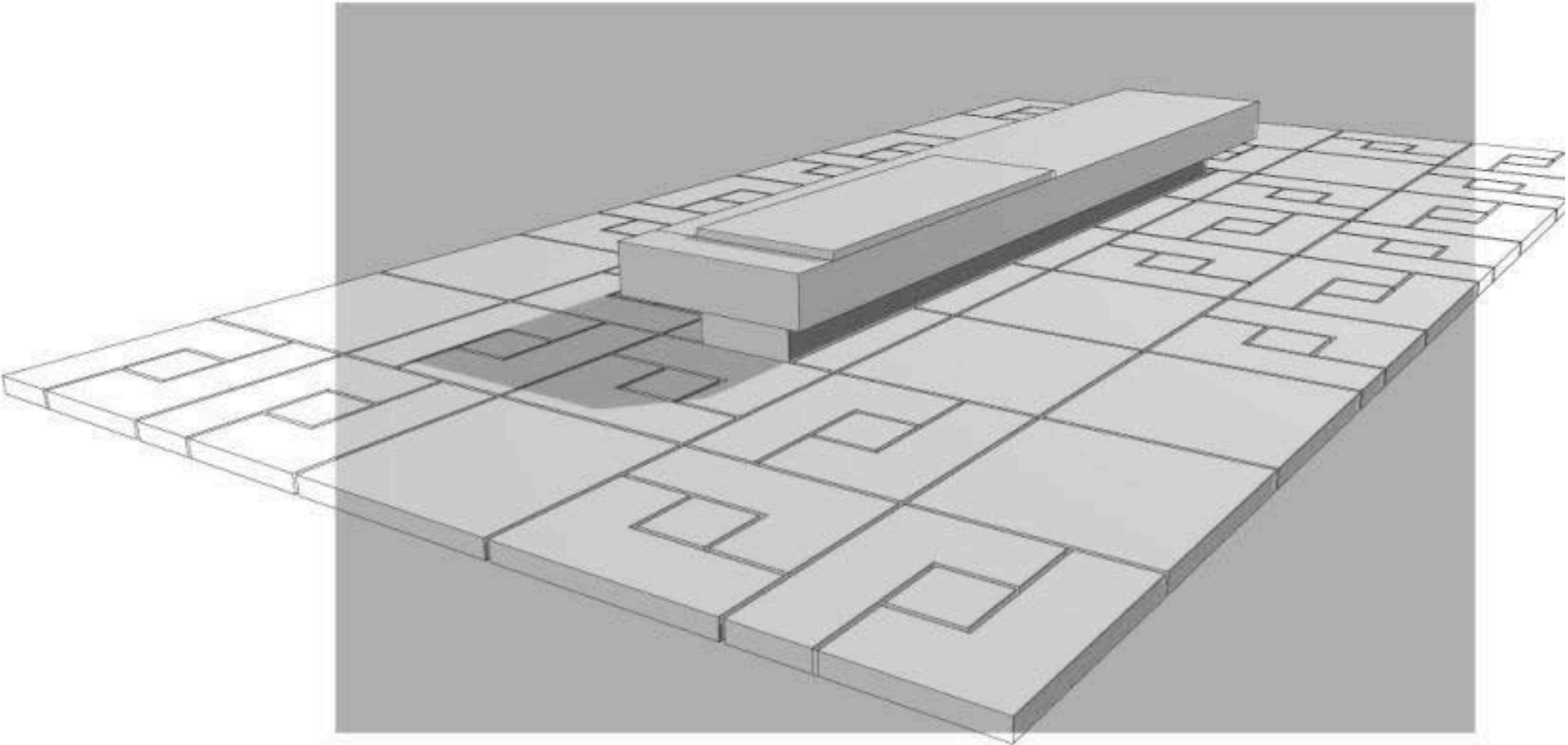
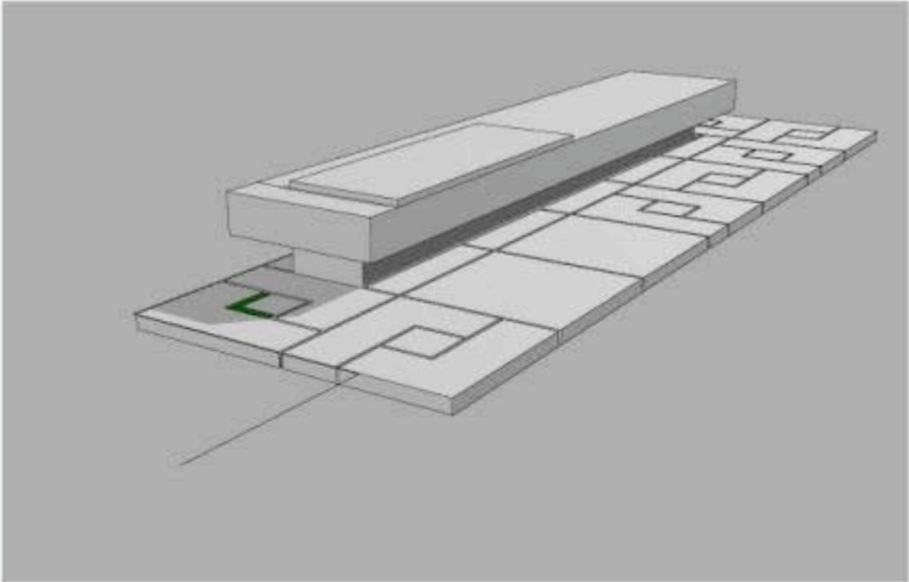

Michael Singer pavings' configurations with MPA benches.

bench @ planting

6" x 6" [with joints]
same central unit of
larger pattern.



planted areas
[hits base of bench]



6" x 12" [with joints]
as suggested by LP



note: verify with MPA, MR, JH
if edge benches are to lie
asymmetrical (one moss 2' x 2'
on one side - other side
planting - or have a 2' x 2'
on each side.

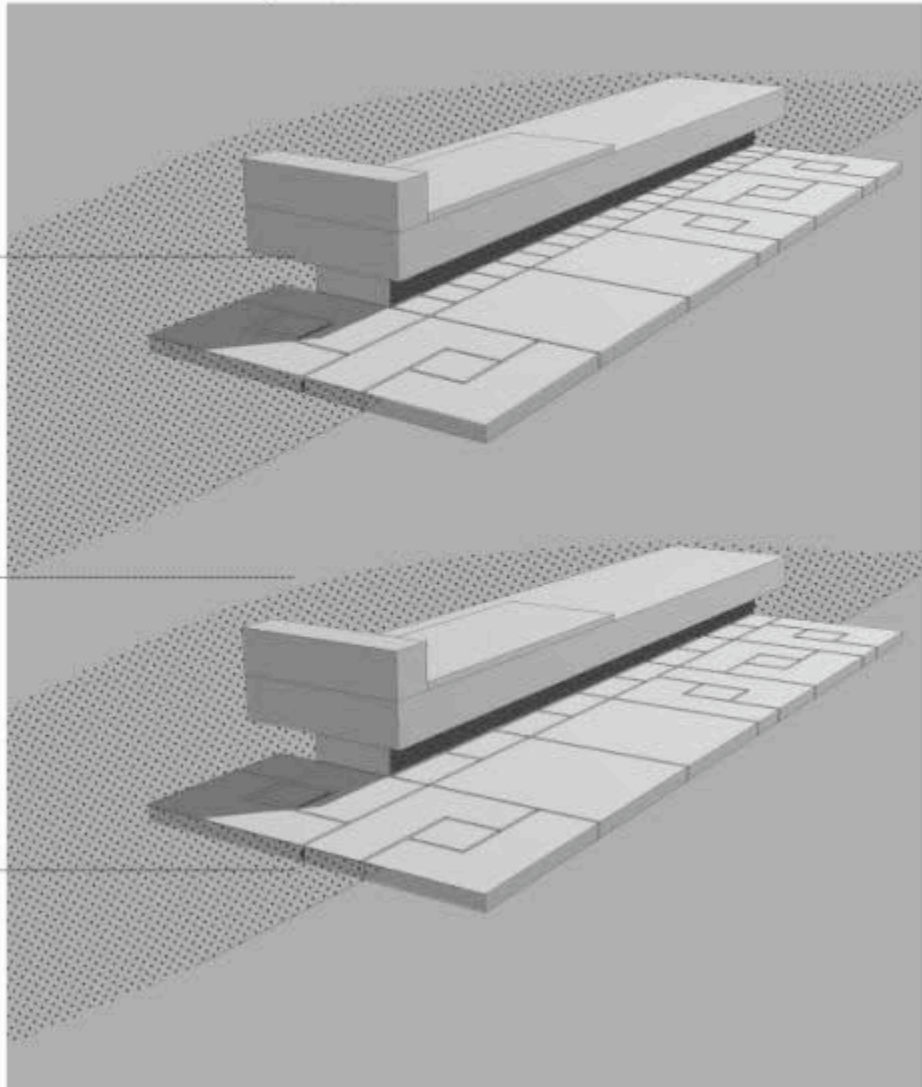

bench @ paving

